



MARINE PARK DRAFT LANDSCAPE CONCEPT



VISION

Marine Park will remain a place of joy for the community and visitors alike, becoming a contemporary design that will enhance its existing essence. A place of play, gathering and learning for further generations to come.



LOCAL CHARACTER

Marine Park is a staple within the Waitara community providing unique opportunity for play, socializing, fishing, swimming and large gatherings. When the sun is out a day will not go by where you won't see a number of locals and visitors participating in fishing, swimming, surfing the bar, using the playground and skate park areas or visiting the cafe.

Native planting with timber walkways and rocky outcrops reinforce the coastal themes and natural elements. Connecting people with the sea and awa has always been apart of the sites history and Marine Park remains one of the few places in NZ that encourages the same activities since precolonial Aotearoa.

Local flora and fauna include large, distinct pohutukawa with well developed exotic pines lining the open turf areas. Grasses and sedges litter the sand dunes and wetland areas with large shrub planting screening the skate park and open grass spaces. Coastal birds and ducks are found dotted around the rocks with the odd seal seen resting along the bar at the river mouth.

There is opportunity to look to improve the amenity and functionality of the site while ensuring the character of Marine Park is retained. Addressing current planting, seating and outdated equipment will begin to improve the parks character into a cohesive design. Providing further opportunity for comfort and active-use will enhance what makes Marine Park so special and will ensure it continues to be a place of pride for Waitara residents for future generations to come.



LOCAL HISTORY

CULTURAL

The whenua (land) currently known as Marine park has been an area where people have gathered for generations (both pre and post European). Relationships with the dramatic beauty of the awa of Waitara and offshore reefs have guided long associations with mahinga kai, sharing and trading of kai and a meeting point for people and families.

The Waitara River is one of the major rivers in the Te Ātiawa rohe and takes its name from the legend of Te Whaitara-nui-a-Wharematangi-i-te-kimi-i-tana-matua-i-a-Ngarue. The Waitara flows through the rohe of the Hapū of Manukorihi, Otaraua, Pukerangiora and Ngāti Rahiri. The name of the Waitara iwi has evolved over the last 160 years. From Ngātiawa to Ātiawa to Te Ātiawa Nui Tonu to the widely accepted name of Te Ātiawa. It should be noted that sections of Waitara iwi still hold to their original name of Ngātiawa. The words Ngāti and Āti mean 'descendants of' and in this particular case they are referring to the descendants of the eponymous ancestor Awanuiārangi.

The Waitara River, unlike other substantial rivers within Taranaki, does not flow directly from Maunga Taranaki but springs from the Manganui River which flows off the mountain and converges with the Waitara River.

The Waitara river mouth was one of the first areas to be settled in Aotearoa and life was sustained there by the abundant resources provided by the reefs and wetlands. There were many kainga (such as Werohia, Kuhikuhī and Huirapa) and tauranga waka with one of the tributaries (mangiti) of the river at the southern edge of Marine park being the mooring site for the largest Te Ātiawa war waka, Eanganui. The kainga also included seasonal fishing villages.

Traditional use of the area has included sea and river fishing. Reefs were alive with shellfish and the river full with a range of fish including kahawai and yellow eyed mullet. Hapū knowledge and archaeological finds have shown that activities supporting fishing surrounded the area. Canoe anchors, fishing net sinkers have all been found.

All elements of the natural environment possess a life force, or mauri. This is a critical element of the spiritual relationship of tangata whenua to the Waitara River which has a spiritual force and personality of its own. The Waitara River has been, and continues to be an integral part of the social, spiritual and physical fabric of hapū and iwi and is celebrated in karakia, waiata and pepeha.

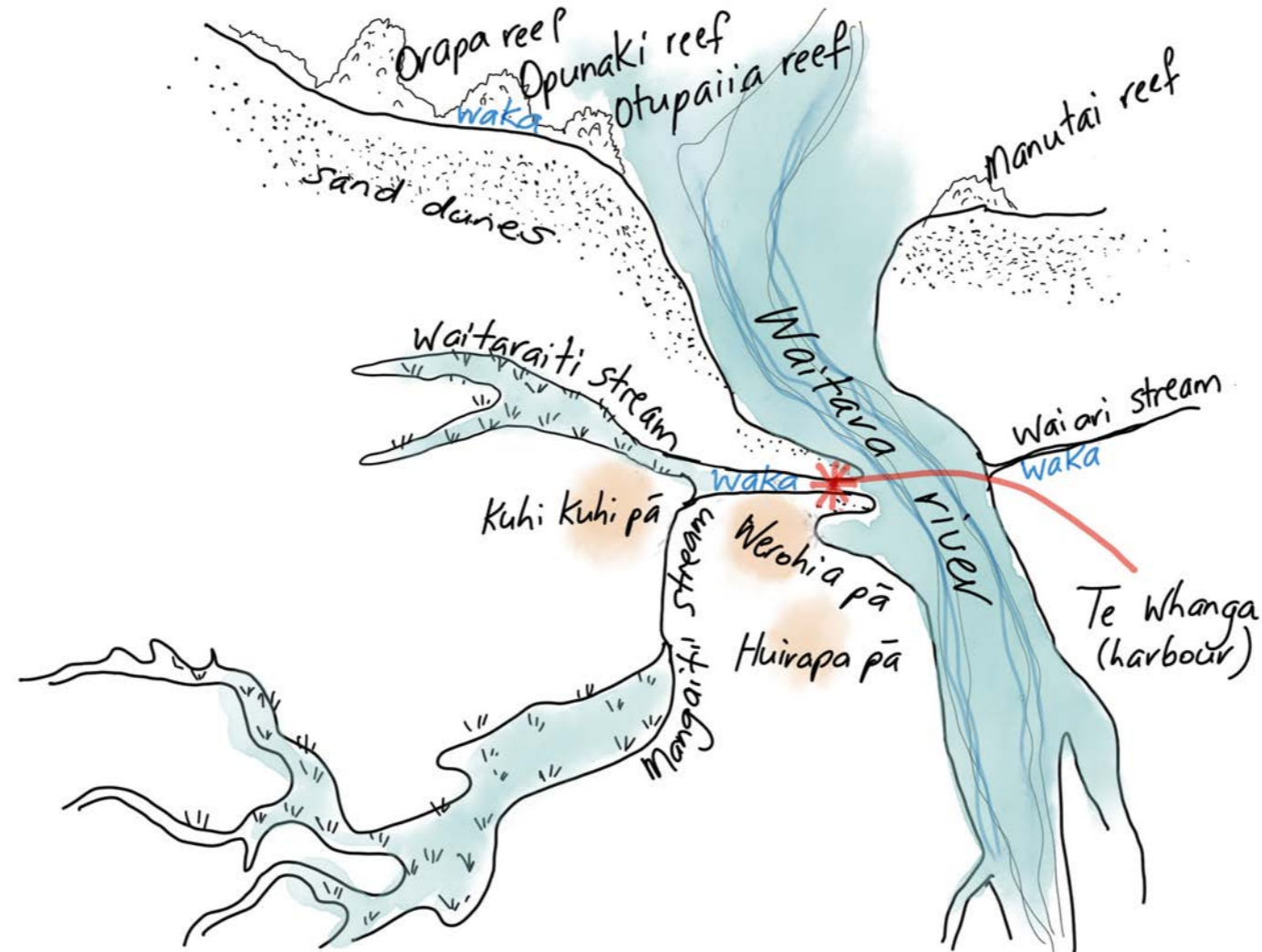

Sketch of pre-european features of Waitara river mouth (from shared knowledge of Hapū of Manukorihi and Otaraua)



Pah at Waitara River Mouth - John Shaw 1861



Huirapa Pa with Waitara Blockhouse - Justin E.D McCarthy 1860



Traditional Maori Hooks

LOCAL HISTORY

VISUAL

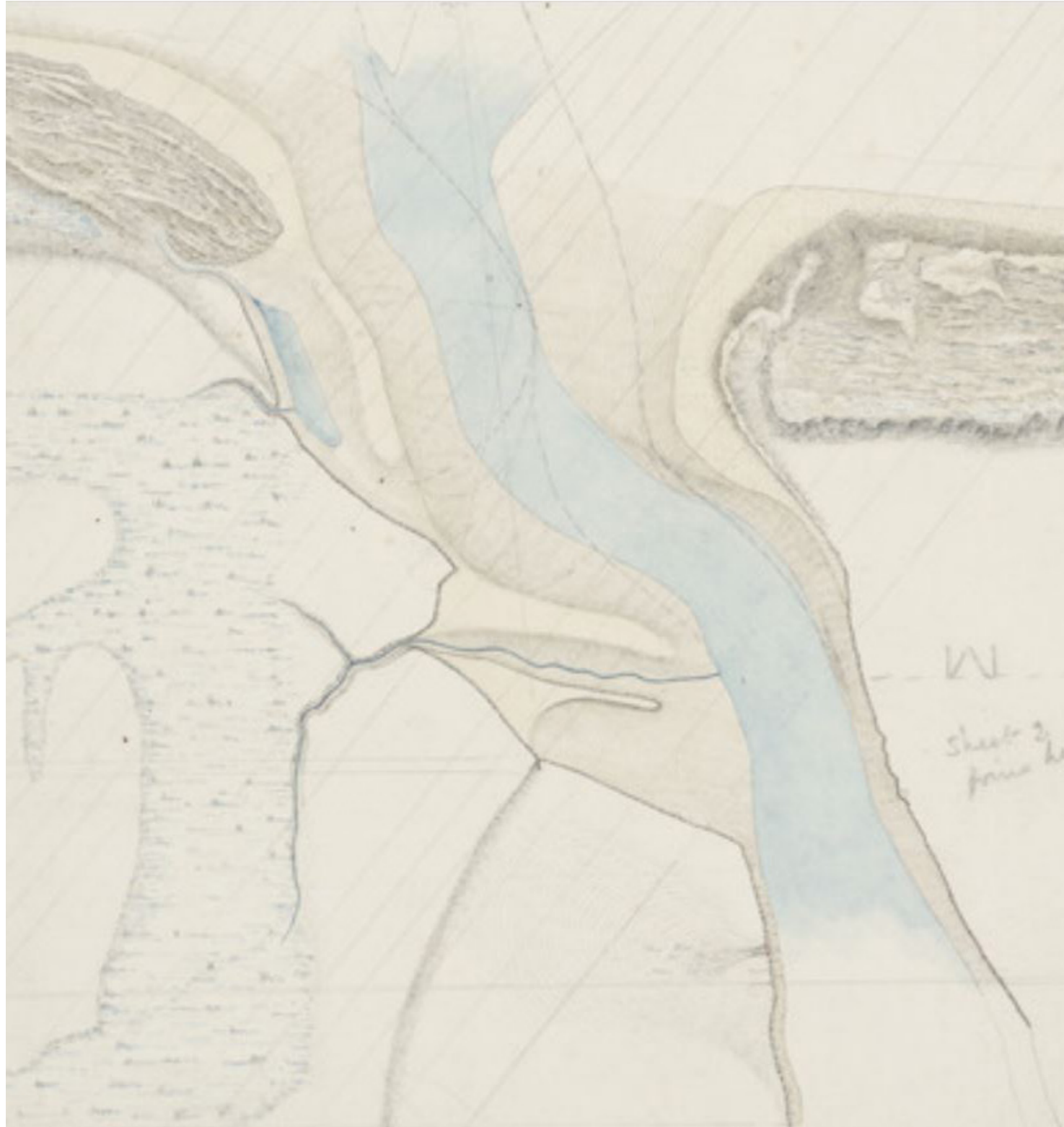

Hand Drawn Map of Waitara River Mouth - 1958

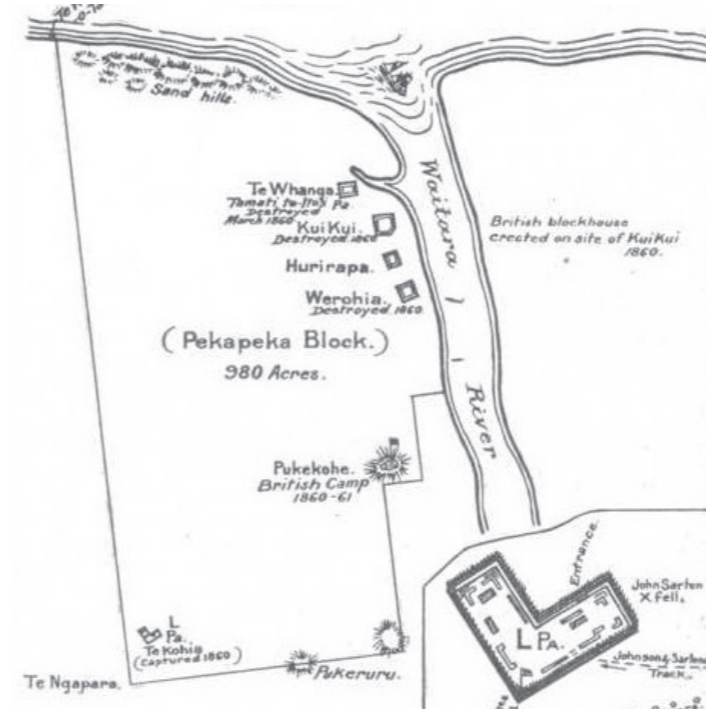

Pah Locations at Waitara River Mouth - 1860



Traditional Maori Fishing Nets - Date Unknown



Ihaia Pah at Waitara River Mouth - William Fraser 1860



Native Pah at Waitara from the Bar - Henry James 1861



Waitara Blockhouse, Hurirapa Pa and Waitara River Mouth - Justin E.D. McCarthy 1860

LOCAL HISTORY

RECENT

The area of Marine park includes a number of features that still exist today and form part of the special character of the area, these include reefs, sand dunes/beaches, sand bars, kainga sites, pa, mangaiti, saltmarsh wetlands and streams.

Post-settlement history includes the river being the location of the first port in Taranaki to engage in international trade, in 1823, when the barque William Stoveld anchored in the river mouth and traded with the Māori. With the establishment of the freezing works in 1872 the river port became even more important. However the sand bar at the river entrance which can only be crossed at high tide, prevented large vessels entering the port resulting it being superseded by the newly established port in New Plymouth.

In the 1960's volunteers from the local Rotary collaborated to establish the access road into the area now known as Marine Park and removed lupins and created the open space area. The shop and playground were soon after added.

Marine park was used during the following decades as a venue for a number of community events, including hosting of the first ever visit to New Plymouth of the Walt Disney characters.

The river continues to be, an important resource for mahinga kai particularly tuna piharau, kahawai, flounder, yellow eyed mullet and herrings. Contemporary uses of the site include cultural harvesting (fish, whitebait) and the site is valued because of its biodiversity and conservation values.

Fishing therefore continues to be a main feature of the activity within Marine park. Annual events such as 'Bring a kid fishing' draw people to the river, both celebrating and honouring the long tradition of mahinga kai.

In recent years Marine Park has provided a perfect location for public events and gatherings. With its proximity to the awa and sea and its large turf areas means it is ideal for hosting large crowds and providing space for activity and interaction. Previous events hosted include the Disney Carnivals of 1971 & 1972 where thousands of people from around Taranaki attended to see their favourite characters, the Waitara Waitangi day event that hosted musical acts and food stalls and the Take a Kid Fishing taking place each year along the awa for the children and families to attend. These are to name but a few with regular boating, fishing, surfing and general gathering events also organised each year at Marine Park.



Marine Park Aerial - 1949



Waitara Aerial - 1958



View of Marine Park when road and open space area put in - Circa 1960's



Newspaper Article from Carnival Extravaganza - 1971



Take a Kid Fishing Event - 2020



Kuvarji Performing at Marine Park - Waitangi Day 2020

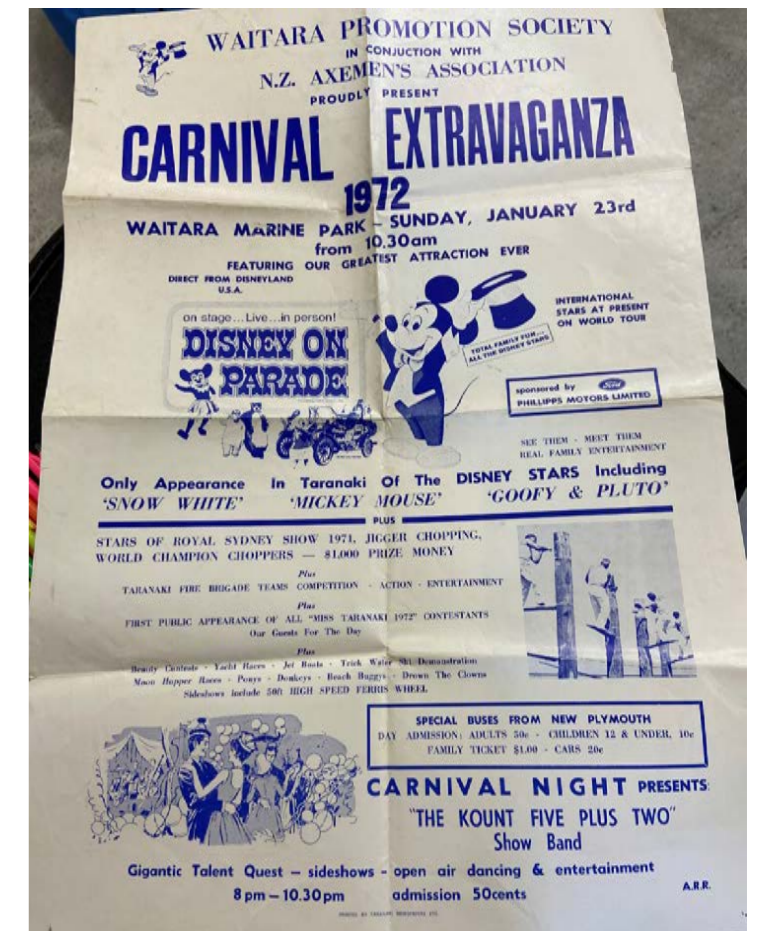

Carnival Extravaganza Posters - 1971 - 1972

DESIGN APPROACH

ENGAGEMENT

Stakeholder and community engagement will be carried out through various workshops and public forums to ensure an informed design approach is achieved. Consideration and input from the active users of Marine Park will help to strengthen the design outcomes while ensuring the voice of the locals is considered.



CONCEPT

Once community engagement has been completed a concept plan will be developed by exploring different outcomes based on the comments gathered. This stage is to experiment and dial in on how to best achieve the most effective design for all users of Marine Park.

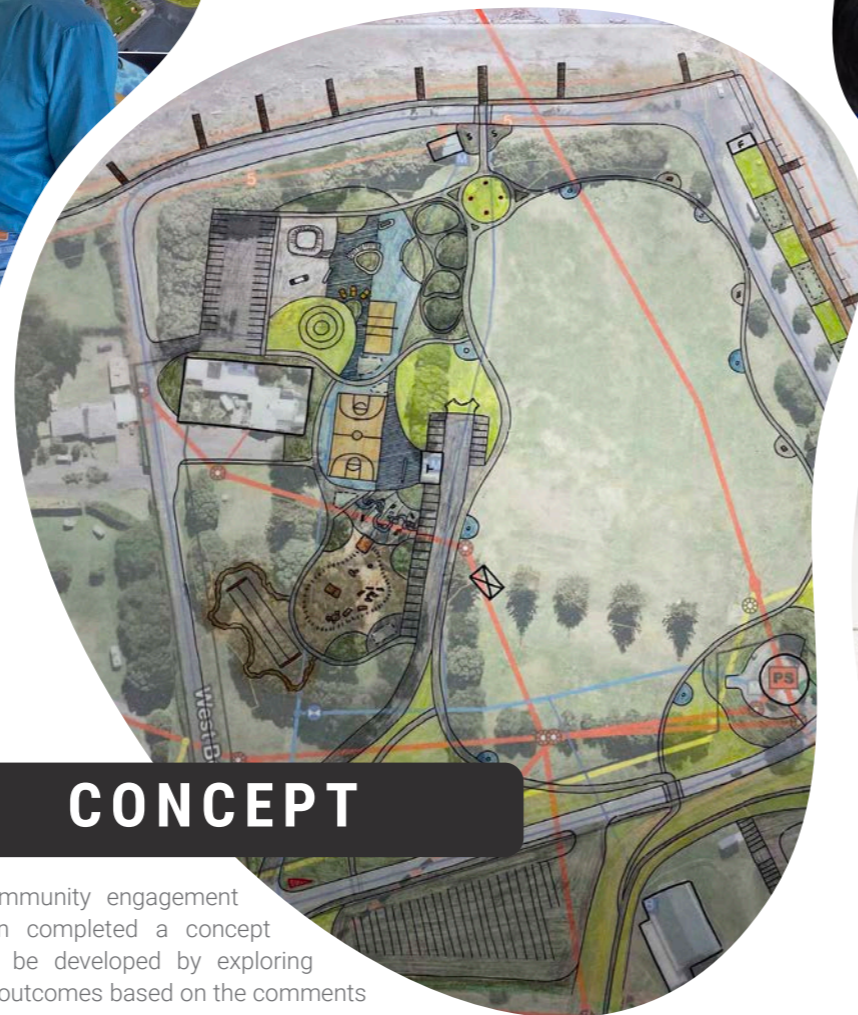

CONSULTATION

With a final concept plan developed one more round of stakeholder and community consultation will be carried out. This will be to show that all of the comments have been addressed and if the design outcomes align with community views.



DEVELOPMENT

After the final comments from stakeholders and community about the presented concept plan, a final design will be developed for construction. Taking on board comments about what does or doesn't work with the concept plan will inform the final development of the design.



STAKEHOLDER ENGAGEMENT

STAKEHOLDER WORKSHOP

The first engagement was on the 13th May with the users of Marine Park. Engaging with those that use the park on a regular basis was important to understand how the park is used and what improvements might be needed.

STAKEHOLDERS

Waitara Community Board
 Department of Conservation
 Te Ara Whakamua o Whaitara
 Waitara Bar Boardriders
 Waitara Lions Club
 Clifton Rowing Club
 Waitara Surfcasters Club
 Waitara Boating Club
 Taranaki Dragon Boaters
 Waitara Canoe and Paddle Club
 Sailability Taranaki
 Waitara Surf Lifesaving
 Waitangi Day Event
 The Beach House Cafe
 Waitara Taiao
 Waitara Off-Shore Fishing
 Waka Ama
 Take a Kid Fishing
 Waitara Youth Centre

MANA WHENUA

Manukorihi
 Otaraua
 Pukerangiora

COMMON THEMES

Tikanga Māori
 Local narrative
 Historical values
 Wahi tapu
 Formal entrance
 Educational
 Renaming

Sound shell
 Improved skatepark
 Improved playground
 Exercise equipment
 Waterplay
 Multi purpose courts
 Shaded picnic tables



CULTURAL



ACTIVE



SAFETY

Vehicle barriers
 Security cameras
 More lighting
 Tree thinning
 Small boat ramp
 Accessibility
 Signage

AMENITY

Improve rubbish facilities
 Improve green shed
 Improved toilet block
 Asphalt carparks
 Fish cleaning stations
 Boat wash / parking
 Power supply



COMMUNITY ENGAGEMENT

COMMUNITY POP-UP SHOP

On the 12th June 2021 a pop-up shop was opened on Mclean Street. The community had the chance to drop in and provide comments and suggestions about what they would like to see at Marine Park. The opportunity to involve community has provided a guide for the design of the park that ensures it responds to the varied needs of the community.

COMMON THEMES

- Improved picnic facilities
- BBQ's
- Sound shell
- Events
- Picnic areas along beach
- Whakairo

- Improved playground
- Finish walkway link
- Improved skatepark
- Pump track
- Exercise equipment
- Improve beach access
- Bike park



SOCIAL



ACTIVE



AMENITY

- Improved toilet block
- Fish cleaning stations
- More carparks
- More public amenity
- Additional bins
- Small boat ramp
- USB chargers



SAFETY

- More lighting
- Vehicle barriers
- Tree thinning
- Signage
- Improve access

YOUTH ENGAGEMENT

WAITARA YOUTH, MANUKORIHI INTERMEDIATE & WAITARA HIGH SCHOOL

Engagement with local youth groups and schools provided for the young people of Waitara to contribute their design ideas for the park. Input from the young people has inspired a design that allows for future generations and encourages youth ownership and pride in the park.

COMMON THEMES

- Improved playground
- Dog park
- Slides and swings
- Waterplay
- Trampolines
- Ziplines

- Multi-purpose courts
- Improved skatepark
- Volleyball court
- Pump track
- Rockwall
- Parkour
- Exercise machines



PLAY



SPORTS



SOCIAL

- Covered gathering areas
- Improved picnic facilities
- BBQ's
- Community garden
- More seating



AMENITY

- Improved toilet block
- More lighting
- Solar power
- Improved rubbish
- Fillet tables
- Free Wifi

ENGAGEMENT FEEDBACK

From the community and stakeholder engagement, feedback was submitted in multiple forms that guided the design process. Allowing comments to be provided in person, group workshops, notes and drawings ensured a good range of ways for thoughts on the park to be noted.



DESIGN PRINCIPLES



PEOPLE

Maintain a soft landscape design along the moana and awa, ensuring that the focus remains a “people first” approach that prioritises comfort and interaction.



CULTURAL

Ensure Mana Whenua and Tikanga Māori is represented throughout the design. Detailed design to explore layouts, the use of materiality, planting, whakairo and learning boards to capture and invoke cultural values.



CHARACTER

The design will seek to only improve and enhance existing areas of the site. Building on existing design foundations to ensure that the existing informal coastal character is maintained and enhanced.

NARRATIVE



“Ko te whanga nohoanga manutai”

“The bay where the seabirds rest”

‘These lands’, wrote Te Rangitāke (Wiremu Kingi) to Donald McLean, the chief land purchase commissioner, ‘will not be given by us into the Governor’s and your hands, lest we resemble the sea-birds which perch upon a rock, when the tide flows the rock is covered by the sea, and the birds take flight, for they have no resting place.’

It is these words Wiremu Kingi used to announce sovereignty over the land, using the metaphor of the seabirds that this is in fact the “resting place” for the Māori people of Waitara. The Waitara river mouth has been a place of rest, gathering and sharing for centuries and it is this essence that Wiremu Kingi wanted to preserve for generations to come.

Image by Dean Wright Photography

LANDSCAPE CONCEPT PLAN



KEY

- ① WALKWAY CONNECTION
- ② IMPROVED SKATEPARK
- ③ IMPROVED FOR PURPOSE GREEN SHED WITH OUTDOOR SHOWERS
- ④ PUMP TRACK
- ⑤ YOUTH ZONE / INFORMAL SPORTS WITH SHELTER, SAND VOLLEYBALL, BASKETBALL COURT & FUTSAL GOALS
- ⑥ PLAYGROUND WITH NET PLAY, CLIMBING TOWERS, ACCESSIBLE PLAY AND INTERACTIVE WATER PLAY
- ⑦ NATURE PLAY WITH FLYING FOX UNDER EXISTING TREES
- ⑧ SURFACED CARPARK
- ⑨ PORTABLE STAGE WITH POWER
- ⑩ CIRCULATION PATH WITH FITNESS NODES
- ⑪ COMMUNITY SHELTERS WITH PICNIC TABLES AND BBQ
- ⑫ STAIR ACCESS TO RIVER
- ⑬ PICNIC ZONE WITH BBQ'S
- ⑭ PICNIC TABLE OPPORTUNITIES
- ⑮ NEW ROAD LAYOUT
- ⑯ PERMEABLE BOAT PARKING WITH BOAT RINSE AND FILLETING TABLES
- ⑰ RAIN GARDEN FOR WATER RUN-OFF FROM BOAT PARKING
- ⑱ STREAM RESTORATION

- TURF
- GARDEN BED
- COASTAL WALKWAY
- PEDESTRIAN PATHS
- ACRYLIC SPORT SURFACING
- RUBBER SOFTFALL
- MULCH SOFTFALL
- ASPHALT
- TIMBER BOARDWALK AND BEACH/RIVER ACCESS
- PROPOSED TREES

SCALE: 1:1500 @A3
MARINE PARK SITE PLAN



LANDSCAPE CIRCULATION PLAN



KEY

- COASTAL WALKWAY (2.4M)
- CIRCULATION PATH (1.5 - 1.8M)
- PEDESTRIAN PATH (1.3M)
- RAISED PEDESTRIAN CROSSINGS
- - - EXISTING PATHS

The priority for circulation around Marine Park is to avoid overwhelming the character of key areas. Directing the wider shared cycle and walking pathway through the center of the park alongside the high activity areas assists to keep the main fast flow of traffic away from the unique character along the awa and encourages visitors to the key play areas (skatepark, sports courts and playground). This approach aims to keep the community gathering areas along the awa can remain a place of relaxation, picnic gathering and fishing without disruption.

SCALE: 1:1500 @A3
MARINE PARK SITE PLAN





YOUTH ZONE

Te Kōwhiri Tū Moana Trust



LANDSCAPE DETAIL PLAN

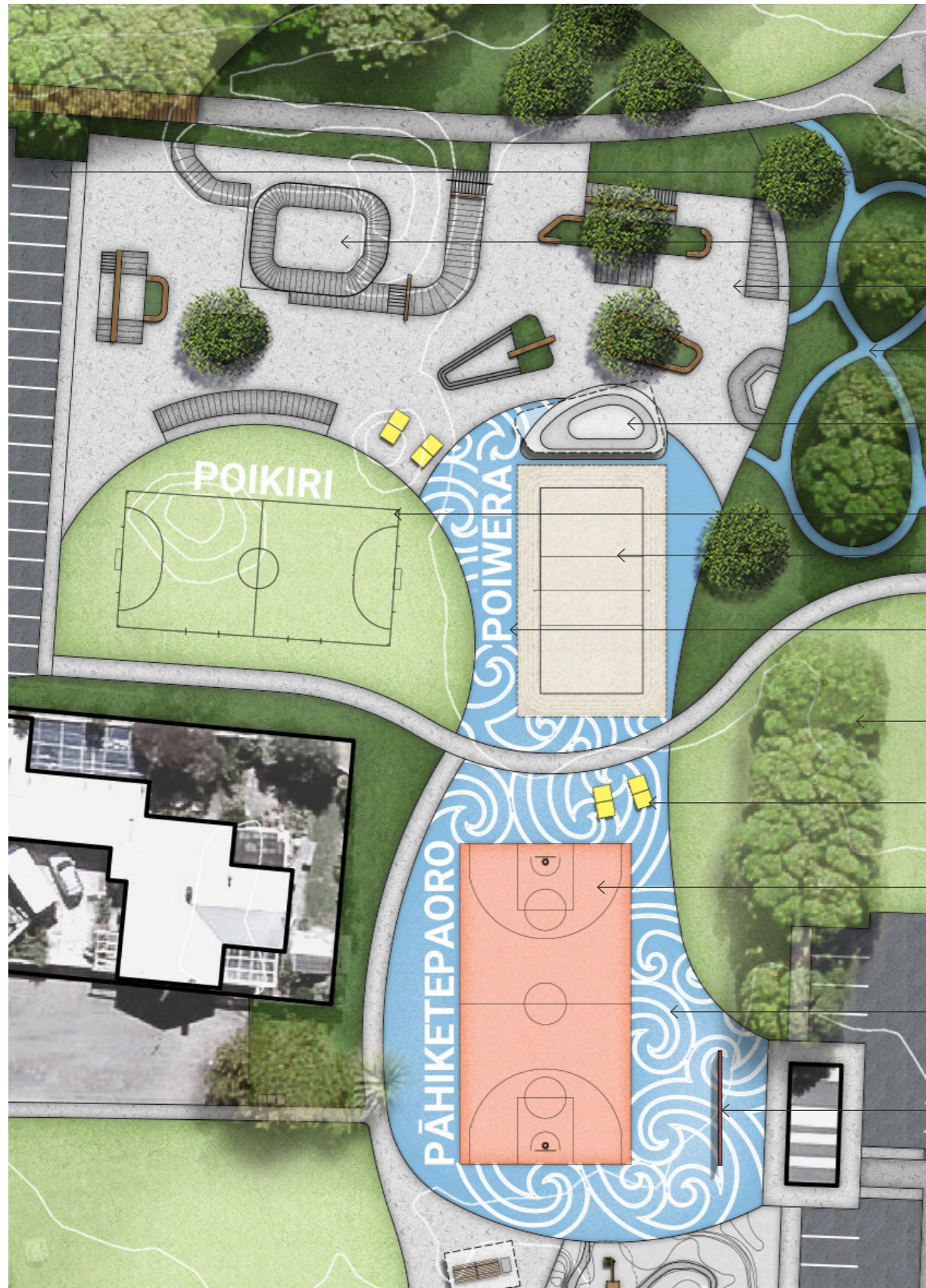

- ← SURFACED CAR PARK
- ← EXISTING SKATE PARK ELEMENTS RETAINED
- ← NEW SKATE LINES AND ELEMENTS
- ← PUMP TRACK
- ← COVERED TIERED SEATING
- ← FUTSAL FIELD WITH GOALS
- ← SAND VOLLEYBALL COURT
- ← MAORI NAME GROUND MARKINGS
- ← EXISTING TREES RETAINED
- ← TABLE TENNIS
- ← RESURFACED ACRYLIC BASKETBALL COURT
- ← GROUND LINE MARKINGS
- ← GAME WALL

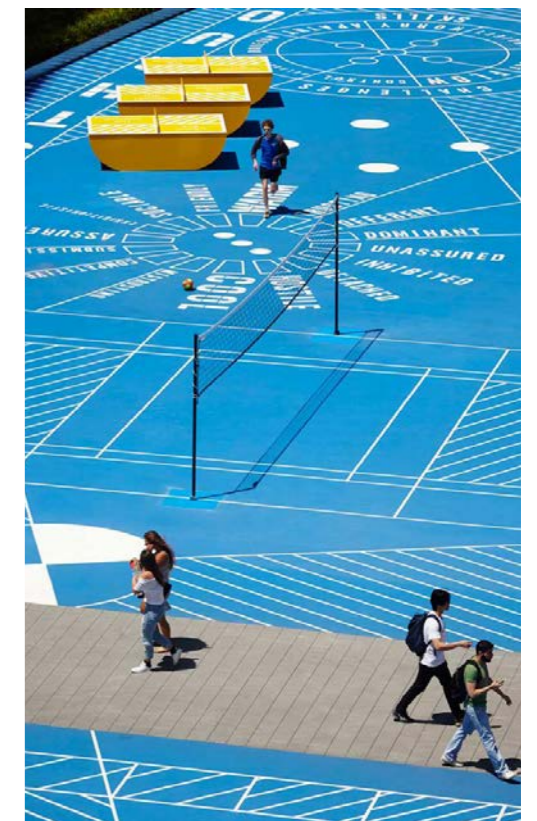
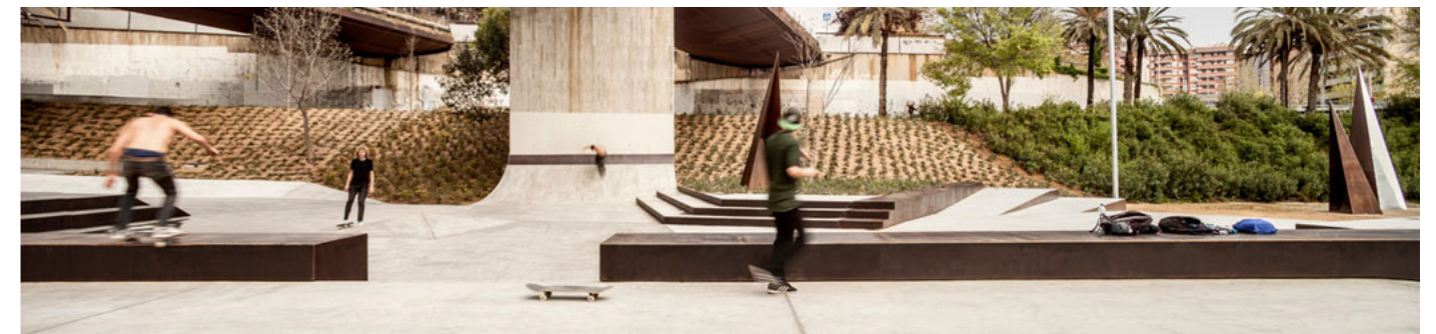

SCALE: 1:500 @A3
YOUTH/SPORT ZONE 

The sport zone is to provide a multitude of differing activities for people to engage in. Improving the skate park and basketball court to a contemporary standard while introducing opportunities for volleyball, futsal, Ki-O-Rahi, table tennis, pump tracks and covered gathering areas making it become a vibrant, engaging space.

PLAY SPACE RENEWAL



LANDSCAPE DETAIL PLAN

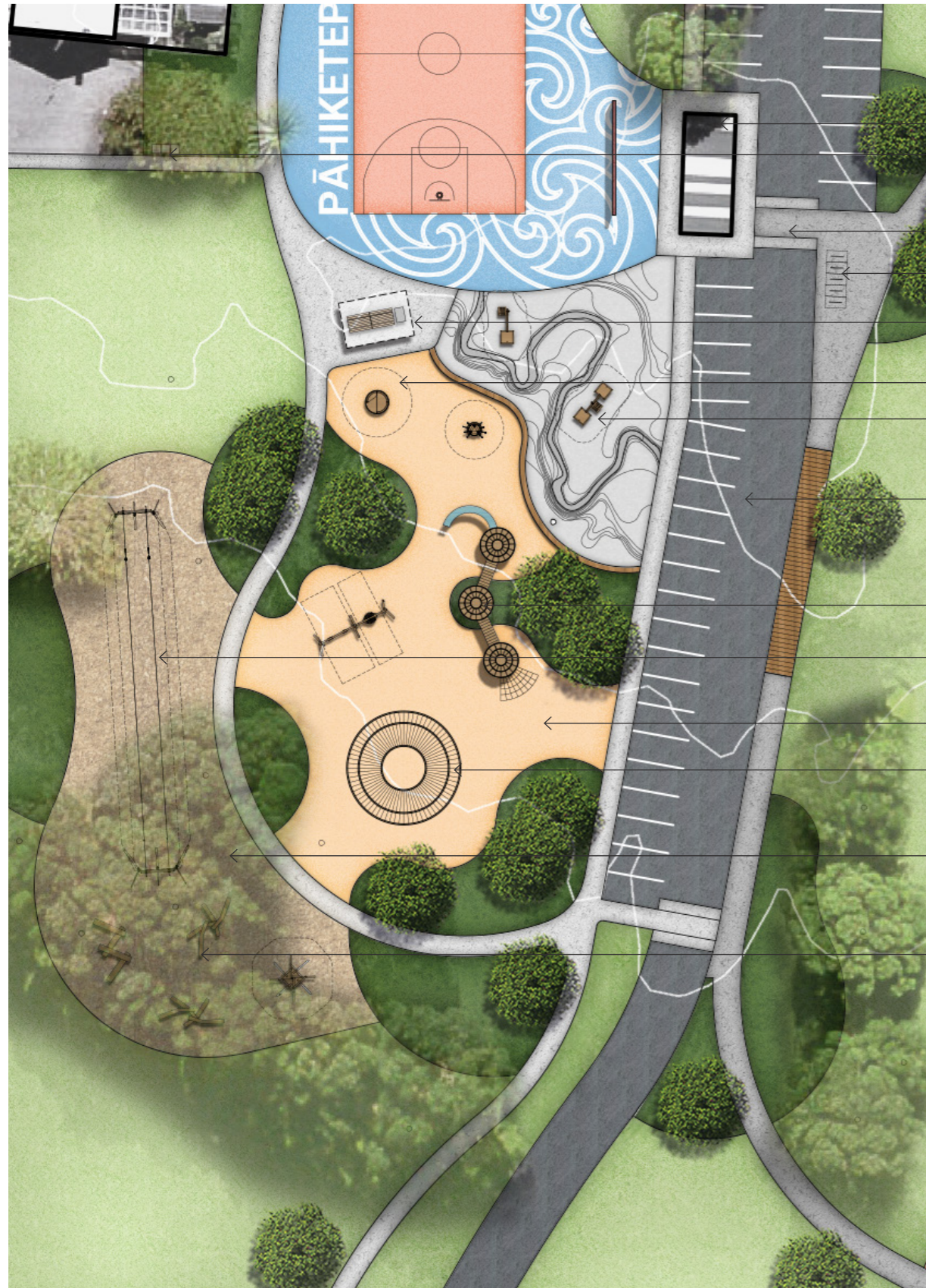

- IMPROVE EXISTING TOILETS
- RUBBISH BINS
- RAISED PEDESTRIAN CROSSING
- BIKE PARKING
- PICNIC TABLE WITH ELECTRIC BBQ
- ACCESSIBLE PLAY
- INTERACTIVE WATER PLAY
- SURFACED CAR PARK
- PLAY TOWERS
- FLYING FOX AND NATURE PLAY UNDER EXISTING TREES
- RUBBER SOFT FALL
- NET PLAY
- EXISTING TREES THINNED AND PRUNED TO INTRODUCE MORE NATURAL LIGHT
- NATURE PLAY ON BARK

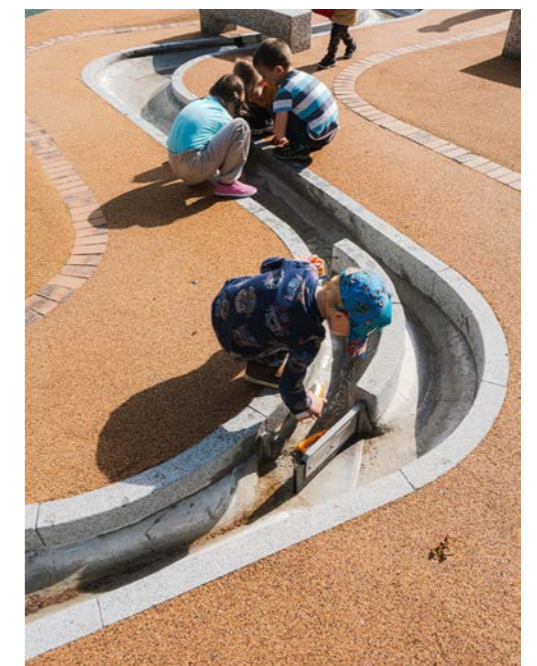
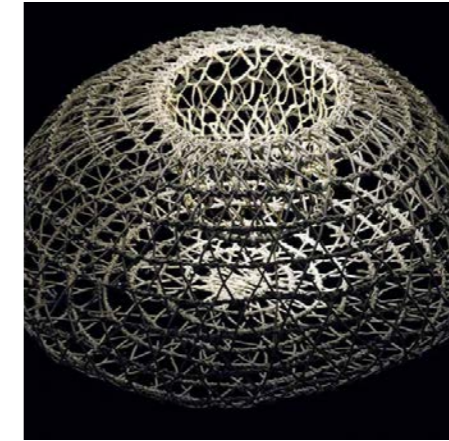

SCALE: 1:500 @A3
PLAY SPACE RENEWAL 

Enhancing the existing play space to reflect the cultural significance of gathering and sharing kai will begin to reinforce the connection to the Waitara Awa. Using water play directly referencing the river, baskets and nets to influence the structures with natural elements begins to reinforce the natural themes of Waitara context.

COMMUNITY ZONE



LANDSCAPE DETAIL PLAN



- AWA ACCESS STAIRS
- FILLETING STATION
- RAISED PEDESTRIAN CROSSING
- RUBBISH BINS
- FITNESS EQUIPMENT
- SHADED PICNIC TABLES
- POTENTIAL TEMPORARY STAGE LOCATION
- LARGE COMMUNITY SHELTERS AND TABLES
- SHADED DOUBLE BBQ'S
- SHADED SINGLE BBQ'S
- FILLETING STATION AND RUBBISH BINS
- FITNESS EQUIPMENT

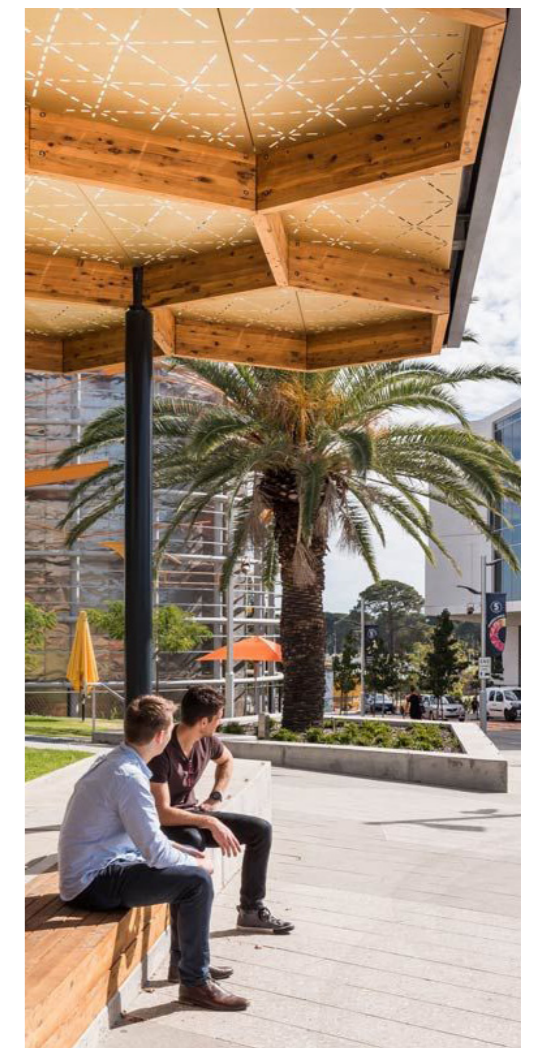
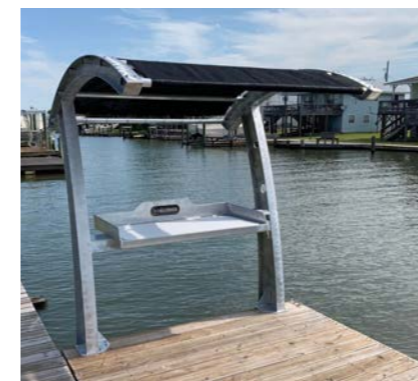
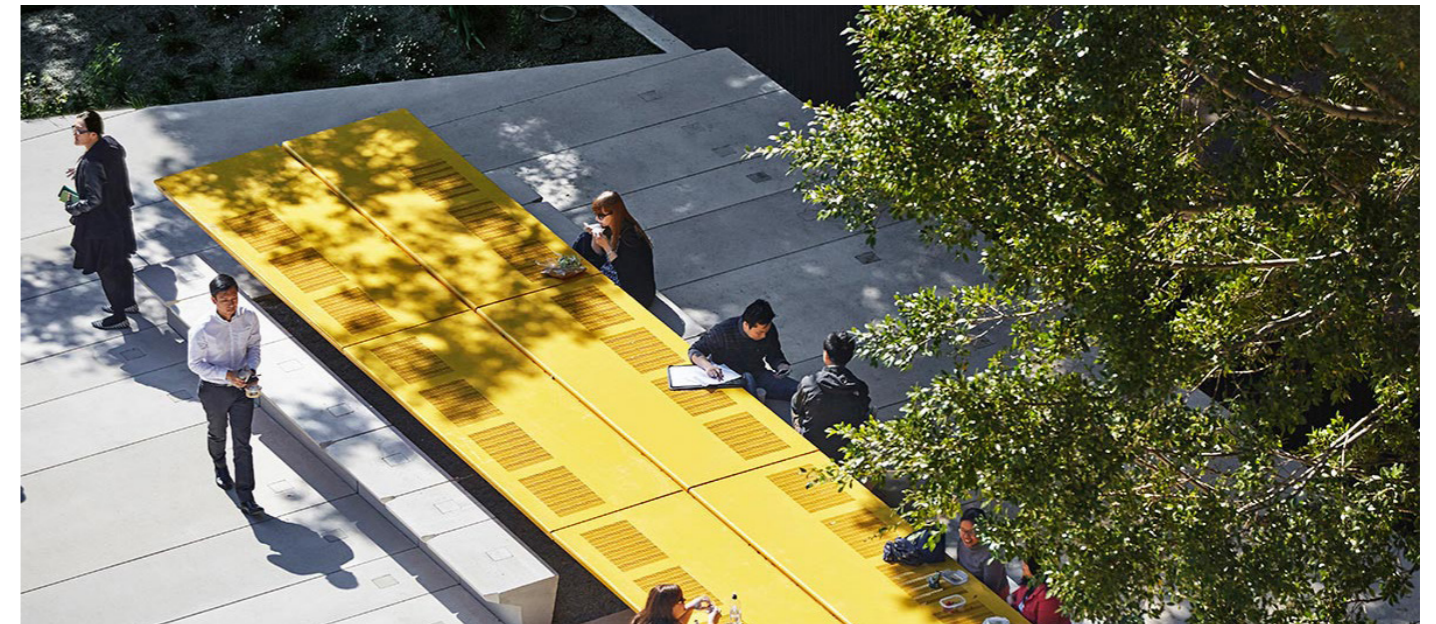

SCALE: 1:500 @A3
COMMUNITY ZONE 

Introducing electric BBQ's, covered picnic tables and larger community shelters/tables for bigger gatherings will look to improve the amenity of the space. Clear separation between fishing/eating and introducing fish filleting stations will ensure that the character of both activities are maintained with stair access to the awa.



BOAT PARKING REVAMP

Te Kōwhiri Tū Moana Trust



New Plymouth District Council

LANDSCAPE DETAIL PLAN



TIMBER DECKING SEATING AREA

PICNIC TABLES

SURFACED ROADWAYS

PERMEABLE BOAT PARKING

RAIN GARDEN WITH TIMBER DECKING

RAIN GARDEN

FILLETING STATION

BOAT RINSE STATION

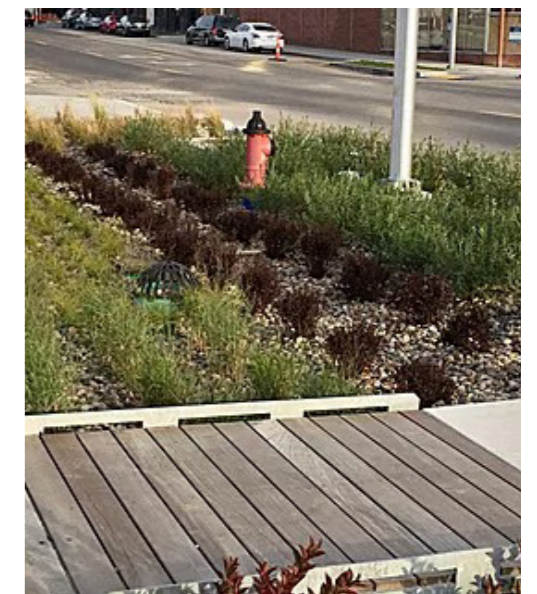

SCALE: 1:500 @A3
BOAT PARKING REVAMP

Providing more picnic tables and a soft public edge aims to encourage further connections to the awa, with rain gardens treating run-off into the river from the roadways and formal boat parking with a boat rinse station and fish preparation station.

MATERIALITY

The material palette will prioritise natural colours that sit well within the landscape. Using neutral, softer tones will help to compliment the awa, moana and planting around Marine Park and avoid overwhelming the senses.



PLAIN CONCRETE



EXPOSED AGGREGATE



ACRYLIC SURFACE (WITH LINEMARKING)



MAORI POU / WHAKAIRO



RUBBER SOFTFALL (NATURAL TONES)



TIMBER AND MULCH FOR NATURE PLAY



COASTAL TIMBER DECKING



TIMBER FURNITURE ELEMENTS



PERMEABLE CARPARK SURFACING

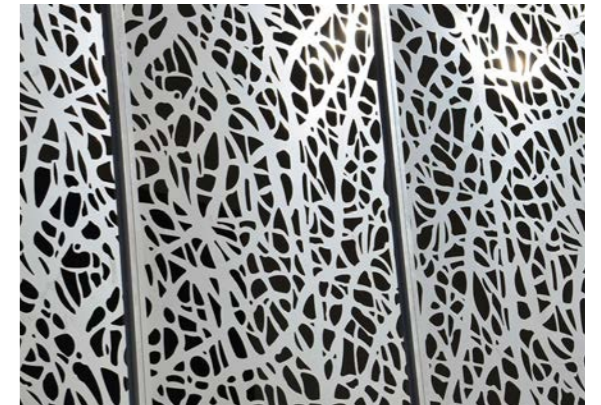

LASER CUT STEEL